

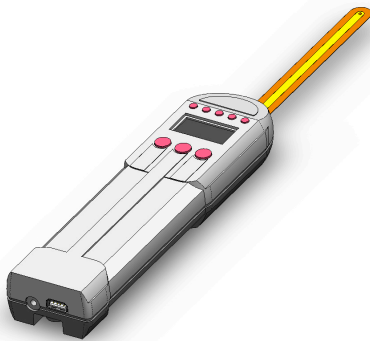

# Gapman<sub>Gen3</sub>

## Gapman® Portable Electronic Feeler Gage



*Gapman with Integral Flexible Wand*

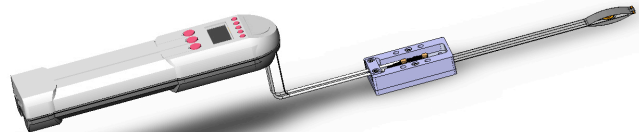

*Gapman with Remote Spring Contact Sabre*

Gapman<sub>Gen3</sub> is the latest generation high precision, non-contact, portable electronic gap measurement gage. It features a dual capacitive sensor for position-compensated measurement and easy insertion into very thin gaps down to 0.0075" (0.190 mm) in a wide range of parallel and roller gap applications. Micro-controller based and application software driven, Gapman records and stores data points for easy transfer to support Six Sigma and other quality systems.

### *Gapman<sub>Gen3</sub> enhancements*

- More compact, lighter weight and more rugged
- Battery life doubled: now 22 hours minimum with 3 AA lithium batteries
- PC based User Interface simpler and easy to use
- Bright blue alphanumeric Active Matrix OLED display
- 10X higher resolution (0.00001" / 0.254 microns)
- $\pm 0.05\%$  full scale repeatability
- USB Type A data and power port
- New Banana Plug 12 foot ground cable
- Easier serviceability / Software Data Reader

### *Applications*

- Aircraft assemblies
- Composite Structures
- Coaters/Extruders
- Laminator roller gaps
- Film production
- Photocopiers/Printers
- Assembled parts

## Specifications

### Gapman Core Unit

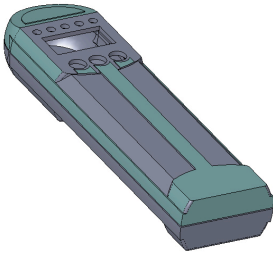

**Size:** 2.2" x 8.7" x 1.1"  
(56mm x 220 mm x 28 mm)

### Thin Sensor Wand GPD-5F-A-200



**Size:** 0.55" x 7.9" x 0.017" (14 mm x 200 mm x 0.43 mm)

### Thin Sensor Wand GPD-4.5(.0075)-A-250



**Size:** 0.55" x 9.8" x 0.0075" (14 mm x 250 mm x 0.190 mm)

Internal Power	3 AA Batteries
Battery life	Application dependent
External Power	USB Type A AC universal power adapter, or laptop PC
Thin Gap Sensor Wands	Select from over 20 standard models, custom wands available
Thin Sensor Wand gap range	Model GPD-5F-A-200 range is 0.017" - 0.118" (0.43 mm – 3.0 mm)  Model GPD-4.5 (.0075)-A-250 range is 0.0078" - 0.118" (0.20 mm – 3.0 mm)
Spring Contact Sabre	Select from several standard models For applications where one or both of the target surfaces are uneven or non-conductive
Spring Contact Sabre gap range	Model GPD-5 (0.22)-A-150 range is 0.025" - 0.118" (0.64 mm – 3.0 mm)
Remote vs Integral Sensor Wands	Remote sensor wand kit available
Target Materials	Measures gaps between all earth grounded metal and composite (CFRP) surfaces



Resolution	0.00001" (0.254 microns)
Repeatability	± 0.05% full scale
Accuracy	± 0.5% full scale
Calibration	Factory preset, traceable to NIST
Menu selection	External buttons for inch/mm and menu short cuts
User interface	Overall design focus on simplicity
Display	Bright blue alphanumeric Active Matrix OLED display
Data output	USB Type A locking to standard USB cable (6 feet)

## 4200GM-Gen3 Standard System includes:

- GPD-5F-A-200 Non-Contact Flexible Sensor Wand, 0.017" - 0.118" (0.43 mm – 3.0 mm) Range
- Gapman Core Unit for Integral Wands, and built in 10,000 point Data Logger
- 2 sets of 3 long life "AA" Batteries
- Coiled Grounding Cable, with 90° banana plug to straight banana plug with gator clip (12 feet)
- USB Power/Data Comm Accessory kit, includes USB Type A AC universal power adapter and USB Type A locking to standard USB cable (6 feet)
- Flat metal to flat metal NIST Traceable Calibration w/Data Sheet
- Supervisor/Programmer Level Manual
- Data Reader Software & Cal Data on CD
- 3-Point Thin Wand Quick Check Block
- Rugged IP67 Grade carrying case